



IBM Cloud Pak for Integration

What's new in CP4I?

Automated Integration Assembly

Leif Davidsen and Matu Agarwal

“Business executives are demanding a path to digital operational excellence.

The net result is tremendous pent-up demand for speed of automation and integration.”

Quote from Gartner - Top 10 Strategic Technology Trends for 2020: Hyperautomation, March 2020



But going fast without the right approach, guided by real-world operational data, will only bet you to the **wrong place faster.**

70%

Of digital transformation projects fail due to **lack of integration quality.**

Sources: Forbes, McKinsey, CMSWire, Gartner Top 10 Trends in PaaS and Platform Innovation, 2020

Integration Architectures are Changing

“Integration has become an obstacle to success because traditional, centralized and systematic integration approaches cannot cope with the volume and pace of business innovation.”

Source: Gartner-Modernizing Integration Strategies and Infrastructure Primer for 2018

Webinar "A cloud native approach to agile integration" - Kim Clark

<https://ibm.biz/agile-integration-cloud-native>

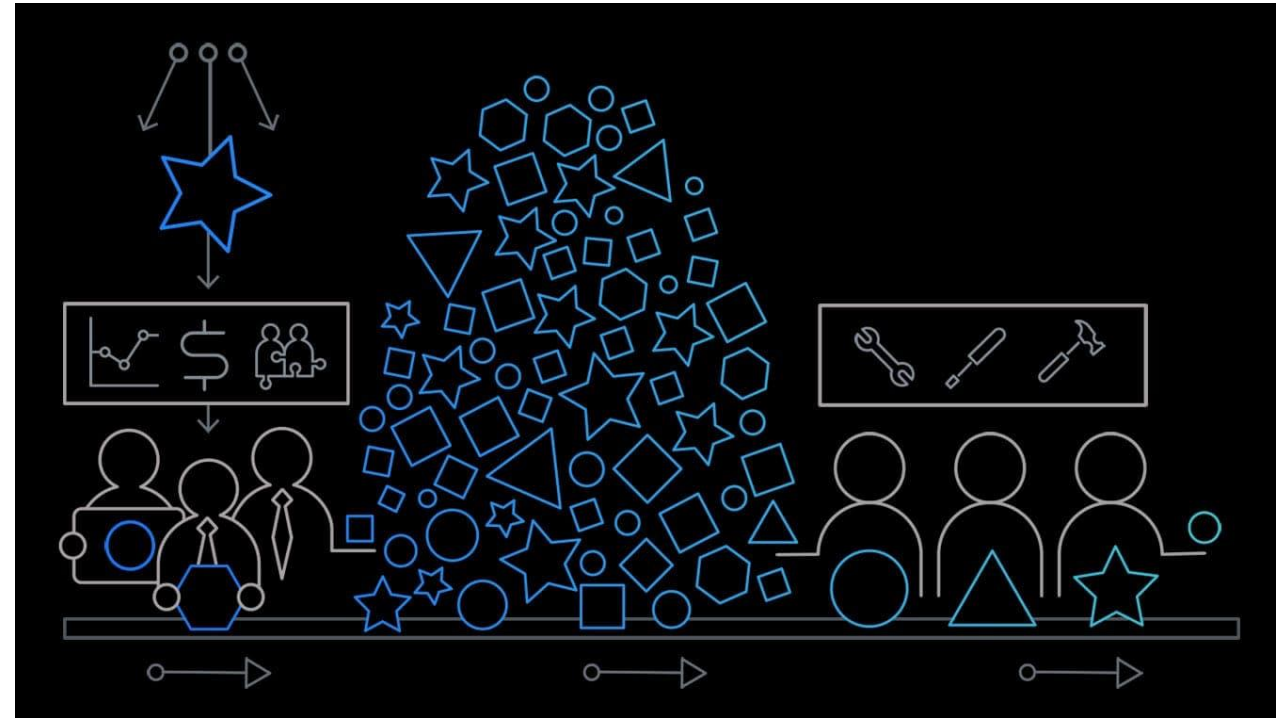

Integration portfolio is bloated

Specialist only dependency hinders scaling of delivery

Lack of interoperability and limited reuse

Successful enterprises integrate faster and ***better***

Intelligently automating every interaction



Manual tasks requiring expert integration skills



Automated integration lifecycle with AI, best-practices and built-in reuse to eliminate the skills barrier



Lack of operational visibility to improve integrations



Closed-loop integration lifecycle that uses real-world, company specific, operational data to identify issues and recommend best practices

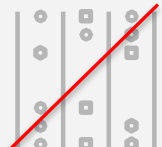

Traditional approach of using only one integration style

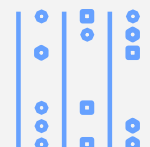

Multi-style integration streamlines using different styles of integration together to deliver faster and better than a one-style-fits-all approach

IBM Automation platform

The most complete set of business and IT Automation services, powered by AI

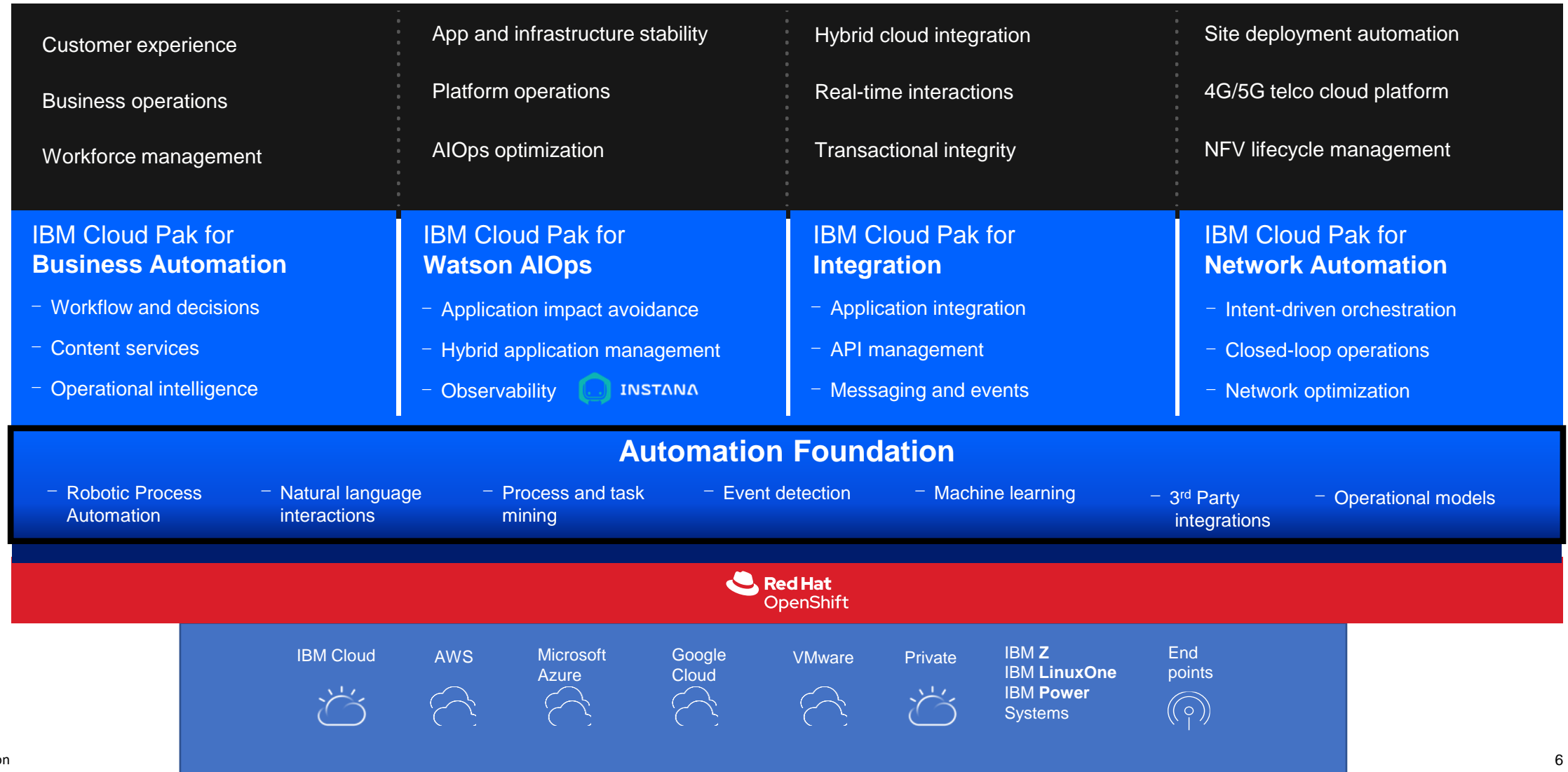

IBM Cloud Pak for Integration

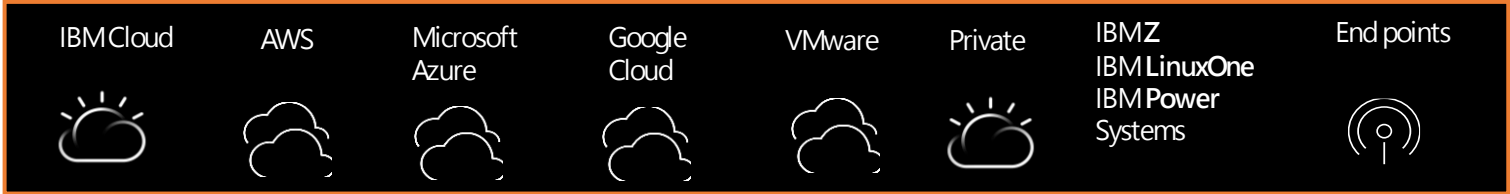
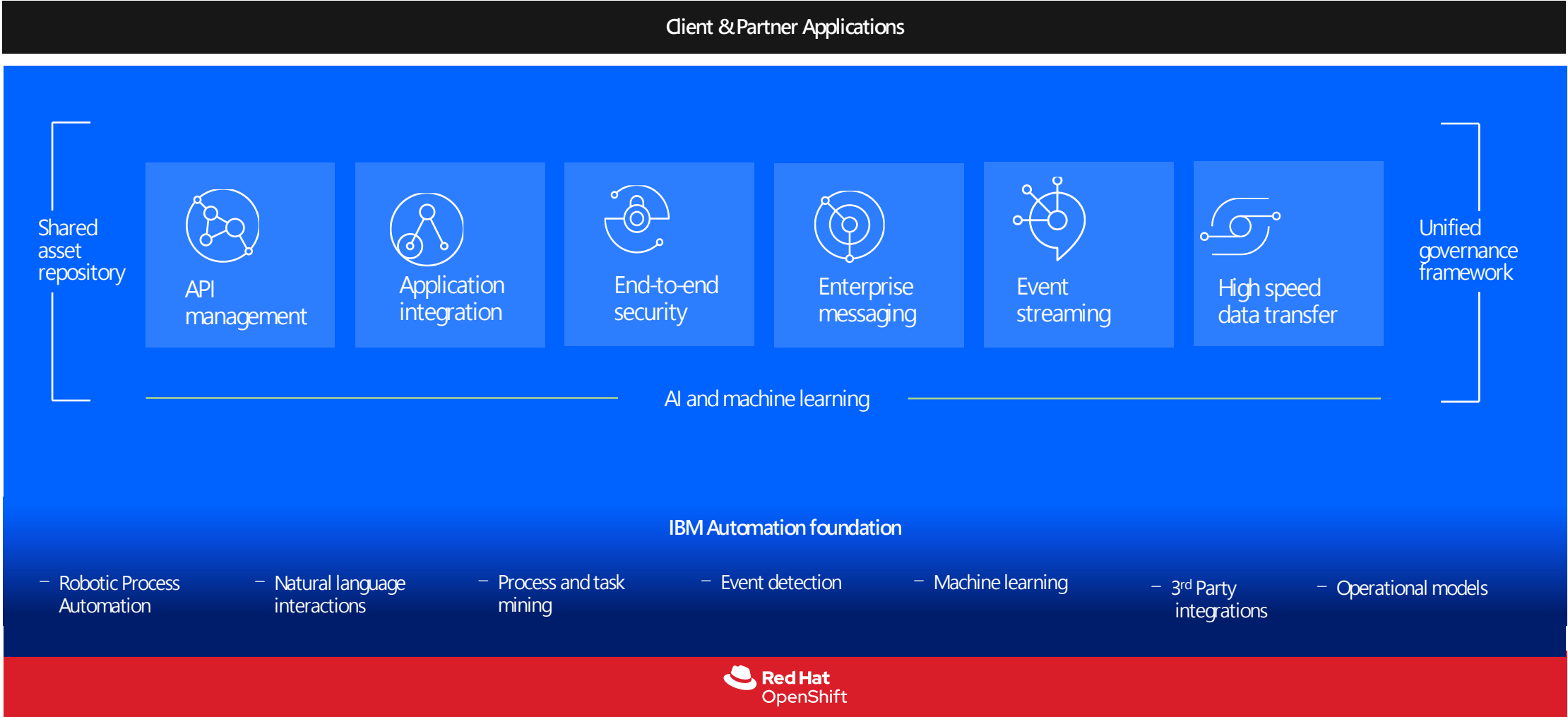

01

Drive new engagement models and digital transformation.

Create and Manage APIs to make core business functions available through new digital channels.

Respond to events in real-time to deliver more engaging customer experiences.

Access data in a fast, secure and reusable way, wherever the data resides.

02

Speed integration while reducing costs

Accelerate delivery with a more agile integration architecture.

Build and deploy new, re-usable integrations in minutes.

Reduce cost and increase reuse and interoperability with simplified operations.

03

Reduce business risks and meet security and compliance requirements.

Secure your business while delivering new engaging services.

Protect transaction integrity across networks and data sources.

Balance workload demands to optimise resiliency and scalability of critical backend systems.

Accelerate delivery with AI-powered integration

Deliver faster with a more agile integration architecture

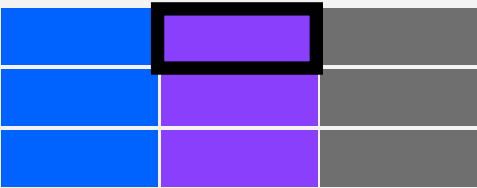

Entry point:

Accelerate delivery with **AI-powered** integration

Scenarios:

- Deploy and update integrations rapidly & seamlessly without impacting existing deployments
- Scale on demand with a robust infrastructure that automatically adjusts to transient peaks in real time
- Make integrations portable, simple to move to new environments & locations to meet capacity growth needs



Make changes quickly
with AI Automation

- Microservices architecture enables updating an integration without impacting other integrations
- AI automation recommends integration patterns, flow mapping and config changes
- Different teams can work on integrations independently - without bottlenecking on a centralized group or infrastructure



Agility through CI/CD
with Automation

- Automated deployment, scaling and self-healing
- Easy to build CI/CD pipeline for containerized integration solutions
- RedHat OpenShift includes streamlined CI/CD workflows helping teams get to production faster



Modern integration runtime
for Automation, Closed Loop & Multi-Style

- Fast, light & dependency free integration runtime
- Runtime supports containerization technologies and orchestration capabilities
- Cloud-first design to explore a deployment without the need to install local infrastructure

Capability: All Components

Designer

No code dev tooling



Simplified integrated design experience to **Create an API in minutes**, pulling in policies and integration artifacts



Increase productivity, **reduce time to market**, with automated API test generation



Easily apply AI through a no code approach to **create intelligent business solutions**



Access to hundreds of pre-built connectors so integration users can focus more on business logic



User centric tooling enables users to start integration projects **with no coding and training**



Mapping Assist

Greatly increase the productivity of your team with AI that simplifies the integration process

Ready to use - AI/ML algorithm is pre-trained to start working as soon as you do and continues to improve suggestions over time as it acquires behavioral knowledge from you

Comprehensive - Mapping Assist considers all applications in a flow when offering mapping suggestions, and not just the prior node in a flow

AI - Mapping Assist's algorithm can provide suggestions not just for flat structures, but also for nested complex objects, arrays, and custom objects

Private and secure - The AI model is deployed where your integrations run, IBM will never view or request to share any of your data

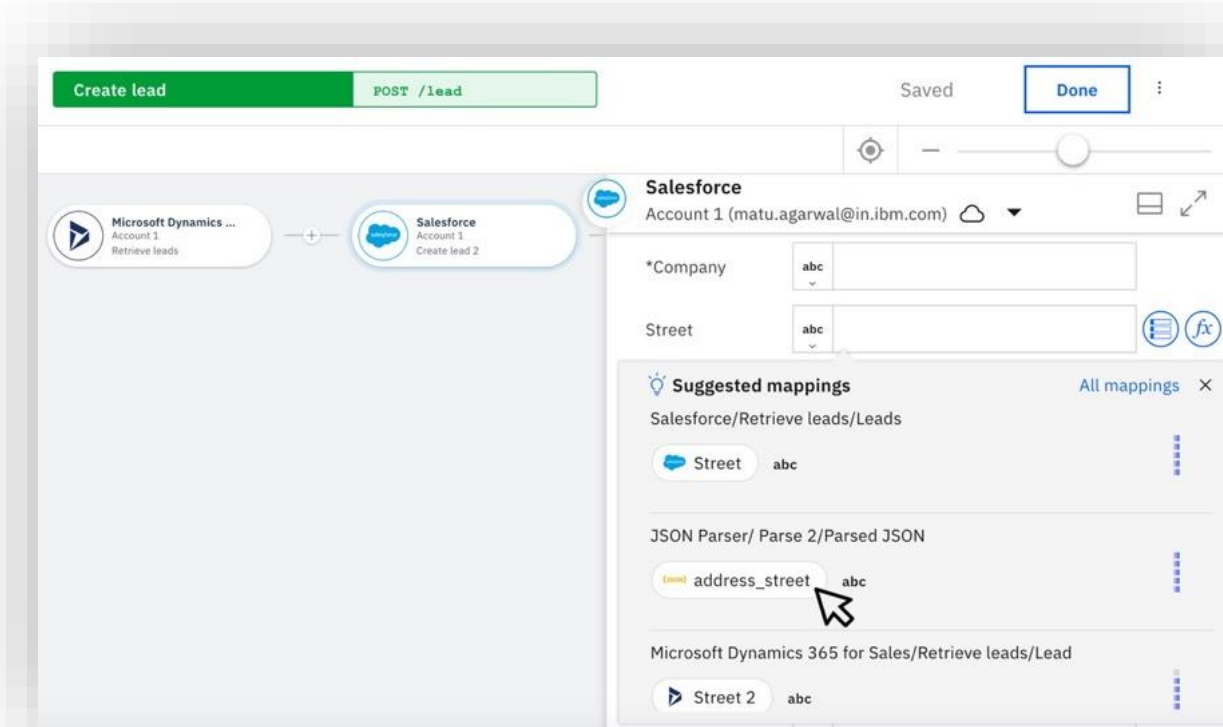

DEMO